



Red Deer College Residence
 Box 5111
 Red Deer, Alberta
 T4N 6P6
 Telephone: 403.342.3257
 Fax: 403.342.3459
 Email: rdc.residence@rdc.ab.ca

RESIDENCE ACCOMMODATION APPLICATION

FOR OFFICE USE ONLY	
DATE APPLICATION RECEIVED AT RESIDENCE	
DEPOSIT DATE	

The information on this form is collected under the authority of the Post-Secondary Learning Act and the Freedom of Information and Protection of Privacy Act of Alberta. The information will be protected in compliance with the provisions of the Freedom of Information and Protection of Privacy Act of Alberta. The information will be used to create and maintain Red Deer College Residence records and will be used for the purposes of Residence application, doing room assignments, Residence billing, and for emergency contact purposes. The information will be retained in accordance with approved Information Management guidelines, after which it will be destroyed in a secure manner. If you have any questions about the collection and use of this personal information, please contact the Red Deer College Registrar, 100 College Blvd., Box 5005, Red Deer, Alberta T4N 5H5 Telephone: 403.342.3300.

NON REFUNDABLE APPLICATION FEE: \$20.00 (Make cheque payable to Red Deer College)

Prospective students may submit this application form prior to being accepted to Red Deer College. To submit an Apprentice or Family Application for Residence – please contact the Residence Office 403.342.3257

PERSONAL INFORMATION

LAST NAME	FIRST NAME	MIDDLE NAME
FORMER NAME(S) IF APPLICABLE	BIRTHDATE (YYYY/MM/DD)	RDC ID #
GENDER: <input type="checkbox"/> MALE <input type="checkbox"/> FEMALE	ADDRESS	
CITY	PROVINCE	POSTAL CODE
COUNTRY	CONTACT PHONE	ALTERNATE CONTACT PHONE
EMAIL ADDRESS	EMERGENCY CONTACT NAME	EMERGENCY CONTACT PHONE
Do you have any health problems or disabilities that may affect your housing options?		
PROGRAM OF STUDY	Year: <input type="checkbox"/> 1st <input type="checkbox"/> 2nd <input type="checkbox"/> 3rd <input type="checkbox"/> 4th	

Choose <input checked="" type="checkbox"/> the term in which housing is required.	
ACADEMIC YEAR (Sept-Apr) <input type="checkbox"/>	Submit on or after October 1st
WINTER TERM ONLY (Jan-Apr) <input type="checkbox"/>	Submit on or after November 1st
SPRING/SUMMER TERM (May-Aug) <input type="checkbox"/>	Submit on or after February 1st

Please refer to www.rdc.ab.ca/residence for information on our housing options. Floor plans are shown on the back of this application.

I require Barrier-Free housing. <input type="checkbox"/>
1 ST Choice of Unit Type: <input type="checkbox"/> 4 Bd Tower <input type="checkbox"/> 4 Bd Cluster <input type="checkbox"/> 4 Bd Block <input type="checkbox"/> 2 Bd Cluster <input type="checkbox"/> Bachelor Unit
2 ND Choice of Unit Type: <input type="checkbox"/> 4 Bd Tower <input type="checkbox"/> 4 Bd Cluster <input type="checkbox"/> 4 Bd Block <input type="checkbox"/> 2 Bd Cluster <input type="checkbox"/> Bachelor Unit
3 RD Choice of Unit Type: <input type="checkbox"/> 4 Bd Tower <input type="checkbox"/> 4 Bd Cluster <input type="checkbox"/> 4 Bd Block <input type="checkbox"/> 2 Bd Cluster <input type="checkbox"/> Bachelor Unit

The purpose of this information is to place you in a room compatible with your lifestyle, when possible. Please answer the following questions HONESTLY.	
Do you have a specific room request?	Is your unit type request more important than your roommate request? <input type="checkbox"/> YES <input type="checkbox"/> NO
I request to live with the following student(s):	
I request to NOT live with the following student(s):	

Do we have permission to give your name & contact information to a future roommate?	<input type="checkbox"/> YES	<input type="checkbox"/> NO	
My personality is:	<input type="checkbox"/> Outgoing	<input type="checkbox"/> Average	<input type="checkbox"/> Quiet/Private
I consider myself to be:	<input type="checkbox"/> A Morning Person	<input type="checkbox"/> A Night Owl	<input type="checkbox"/> In Between
When it comes to parties, I like to party:	<input type="checkbox"/> Anytime/Anywhere	<input type="checkbox"/> Small Get-togethers	<input type="checkbox"/> Rarely or Never
I consider myself to be:	<input type="checkbox"/> Quiet	<input type="checkbox"/> Loud	<input type="checkbox"/> In Between
I prefer my unit to be:	<input type="checkbox"/> Clean/Tidy	<input type="checkbox"/> Average or Lived In	<input type="checkbox"/> OK to be messy
My roommates might be :	<input type="checkbox"/> In my Program	<input type="checkbox"/> From my hometown	<input type="checkbox"/> Christian
My roommates might enjoy:	<input type="checkbox"/> Studying	<input type="checkbox"/> Sports	<input type="checkbox"/> Gaming
Additional information:			

PAYMENT OF THE \$20.00 APPLICATION FEE MUST BE INCLUDED WITH THIS APPLICATION.

We accept the following methods of payment:

- 1) FAX your Residence Application and Credit Card Information to 403-342-3459. *Please write your credit card information on a separate cover sheet. This information will be confidentially destroyed after it is processed. In addition to the credit card number, we require the expiry date and 3 digit security code from the back of the card. NOTE: Please be aware that there are risks associated with the transmission of your credit card information by fax or mail (e.g. loss or theft).*
- 2) Mail this application and payment (cheque or money order payable to Red Deer College) to:
Red Deer College Residence
Box 5111
Red Deer, AB T4N 6P6
- 3) Pay in person at Red Deer College Residence Administration or the Cashiers on the Main Campus.

The Residence Manager may request additional information and/or refuse to accept this application. Applications that are incomplete will be returned.

SIGNATURE OF APPLICANT	DATE OF APPLICATION
------------------------	---------------------

For more pictures and information about Residence, please check us out online at www.rdc.ab.ca/residence



Four Bedroom Tower

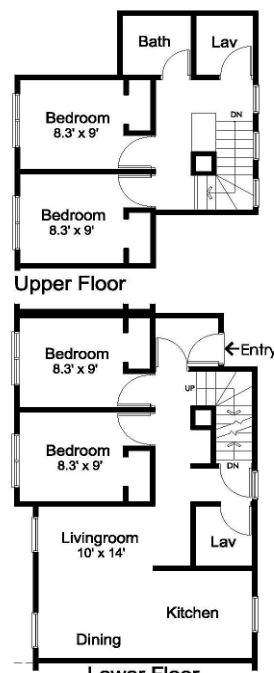

Four Bedroom Cluster

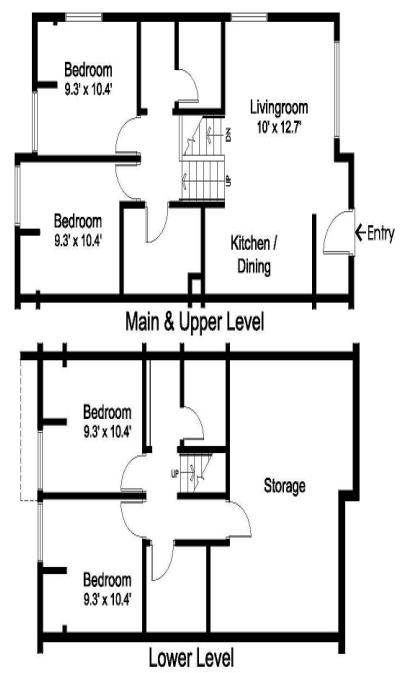

Four Bedroom Block Rowhouse